

FX3G

MELSEC Compact PLC

Extending your options

A new choice for comprehensive machine control

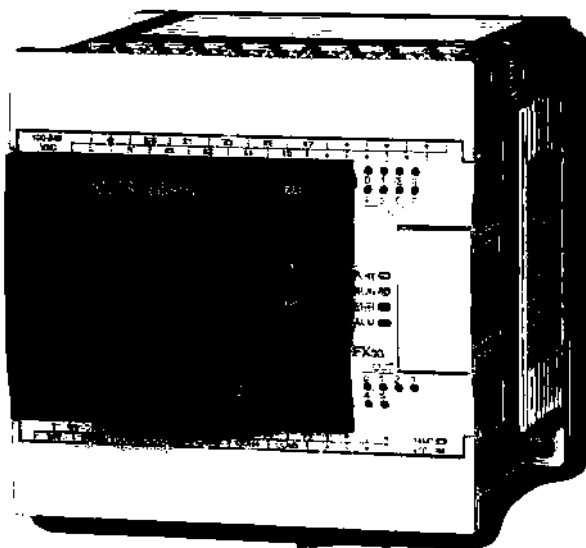

PROVEN
TECHNOLOGY 

Applies the proven FX3U design to smaller but performance critical applications

FLEXIBLE
DESIGN 

Add a variety of capabilities to suit specific application needs

SHORT LEARN-
ING CURVE 

Builds on existing FX series hardware and programming for quick adoption and investment protection

EASY
INTEGRATION 

Direct control of inverter and motion control systems with no extra hardware

FX3 power, compressed

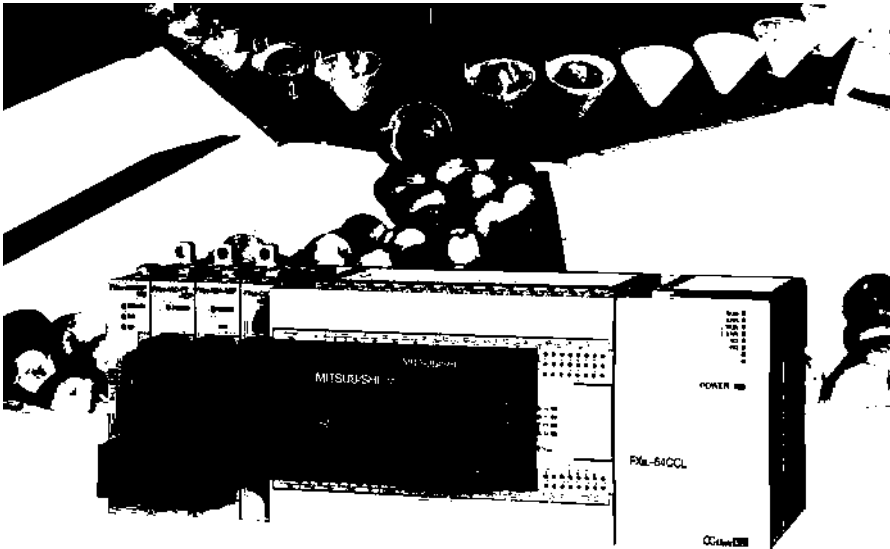

FX3G has the versatility to handle applications from a wide range of industries.

More for less

While being intended for smaller systems, the FX3G still delivers a powerful combination of essential features, plus more not expected from a controller at this level. These include; a large program memory to implement sophisticated algorithms, ample space for data storage, logging or recipes, plus high speed execution to enhance system productivity. A dual bus architecture provides flexible expansion possibilities for additional I/O capacity and communication functions.

Easy system integration

The FX3G can operate as a standalone controller, but for when integration with other system components is required, a range of standard features makes it stand out from the crowd. Mitsubishi builds in standard instructions that permit easy control of our inverters over a precise, reliable digital link. This makes it simple to connect an inverter such as a FR-D700 to provide more precise motor operation while optimizing energy use.



Mitsubishi Electric Corporation Himeji Works is a factory certified for ISO14001 (standards for environmental management systems) and ISO9001 (standards for quality assurance management systems)

Feel our strength

Mitsubishi Electric is the undisputed world leading supplier of compact PLCs. We originated the concept of this type of controller over thirty years ago. Our global installed base exceeds 9 million systems and our philosophy of listening to customer needs insures this base continues to grow. The introduction of the FX3U PLC set a new benchmark for performance and flexibility in the compact PLC market and we have continued to innovate. The result is the FX3G, our new answer to applications needing FX3U like capabilities in smaller scale systems.



Precise motor control with digital links

Motion control is also simple to implement. The FX3G provides direct control of up to three independent axes without any additional hardware. Hence cost effective multi-axis systems can be built without requiring a costly controller overhead.

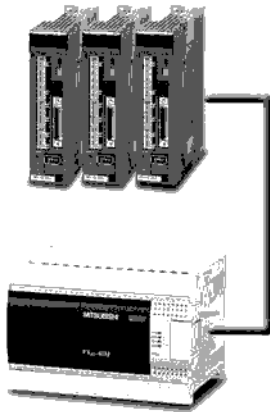

Direct motion control of up to three axes without further hardware

Easy expansion

When it comes to increasing the capabilities of an FX3G, we extend your options while protecting your skills and investments. The dual bus architecture provides twice as many expansion possibilities compared to previous designs. On one bus, the FX3G uses additional, familiar FX family I/O and special function blocks to add a comprehensive variety of I/O and special function capabilities such as analogue and networking. On the other system bus, the FX3G uses the existing FX3U special adapters to provide high performance communication and analog capabilities that are

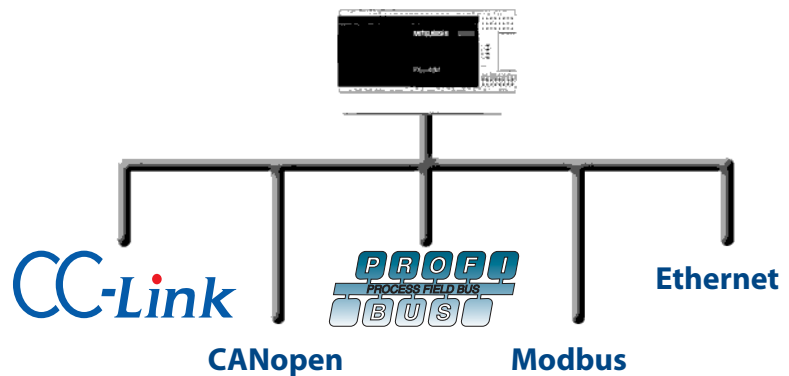

Comprehensive open network connectivity support

directly linked to the CPU. This reduces programming while increasing performance, leading to faster development and higher productivity.

The great communicator

Finally, the FX3G offers you a wide selection of options when it comes to networking and communications. This begins with standard serial communication support and builds up to comprehensive coverage of common open automation networks. These include CC-Link, CANopen, Profibus-DP and Ethernet. Further, a built-in USB port makes permits convenient connection to any PC or laptop for high speed program uploads and downloads along with monitoring.

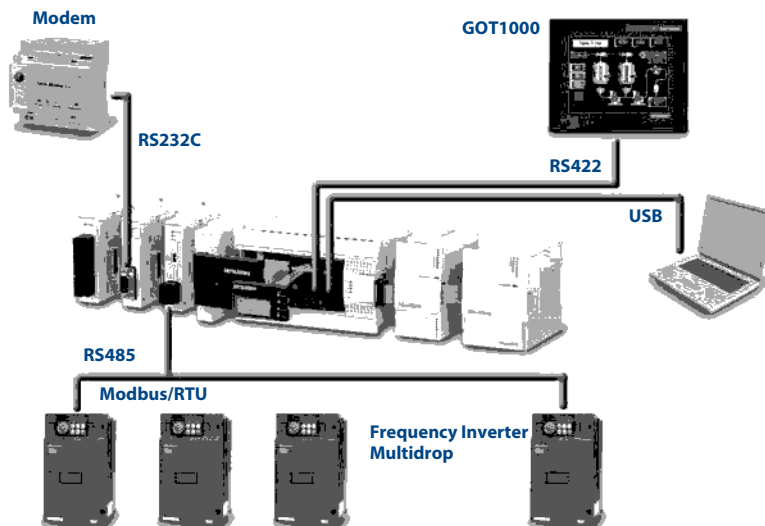

The FX3G makes building complete systems easy.

Specifications ///

Specifications	FX3G-14M□	FX3G-24M□	FX3G-40M□	FX3G-60M□
I/O points	256 total (combined local and CC-Link remote I/O)			
Address range	Max. 128 direct addressing and max. 128 remote I/O			
Power supply	100–240 V AC (+10 % / -15 %), 50/60 Hz			
Program memory	32,000 steps EEPROM (internal), exchangeable EEPROM memory cassette with loader function			
Instruction Time	0.21 µs or 0.42 µs / contact instruction			
Integrated inputs	Number of inputs	8	14	24
	Input signal voltage	24 V DC (±10 %)		
	Input form	sink/source		
	Response time	Approx. 10 ms		
Integrated outputs	Isolation	Photocoupler isolation		
	Number of outputs	6	10	16
	Switching voltage	<240 V AC, <30 V DC (relay output), 5 – 30 V DC (transistor output)		
	Output type/form	Relay or transistor		
Max. load	resistive	2A/point, max. 8 A total (relay), 0.5 A/point; max. 0.8 A for 4 output points/common terminal (transistor)		
	inductive	80 VA (relay), 12 W/point (at 24 V DC); max. 19.2 W for 4 output points/common terminal (transistor)		
Response time	10 ms (relay), < 5 µs (for Y000 and Y001) / 0.2 ms (for all other outputs) (transistor)*			
Isolation	Photocoupler isolation			
High-speed counters	21 total, with 16 1-phase (C235 - C250) and 5 2-phase (C251 - C255)			
High-speed outputs	-2,147,483,648 to 2,147,483,647			
24V DC service power supply	400 mA			
Environment	0 – 55 °C ambient temperature; 5 – 95 % relative humidity			

* The 40 and 60 I/O point transistor output base units have a 5µs response time for Y002

Dimensions

PLC	X
FX3G-14M□	90
FX3G-24M□	90
FX3G-40M□	130
FX3G-60M□	175

All dimensions in mm

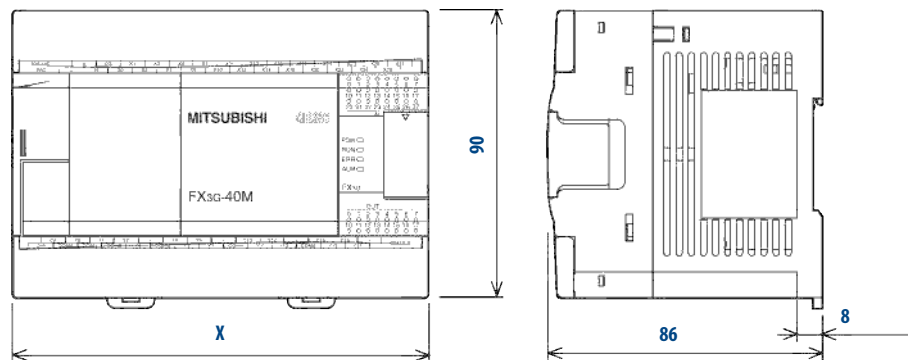

EUROPEAN BRANCHES

MITSUBISHI ELECTRIC EUROPE B.V. D-40880 Ratingen Phone: +49 (0)2102/486-0	GERMANY
MITSUBISHI ELECTRIC EUROPE B.V. Radlická 714/113a CZ-158 00 Praha 5 Phone: +420 (0)251 551 470	CZECH REPUBLIC
MITSUBISHI ELECTRIC EUROPE B.V. 25, Boulevard des Bouvets FR-92741 Nanterre Cedex Phone: +33 (0)1/55 68 55 68	FRANCE
MITSUBISHI ELECTRIC EUROPE B.V. Viale Colonnello 7 I-20041 Agrate Brianza (MB) Phone: +39 039/60 53 1	ITALY
MITSUBISHI ELECTRIC EUROPE B.V. Krakowska 50 PL-32-083 Balice Phone: +48 (0)12/630 47 00	POLAND
MITSUBISHI ELECTRIC EUROPE B.V. Carretera de Rubí 76-80 E-08190 Sant Cugat del Vallés (Barcelona) Phone: 902 131121 // +34 935653131	SPAIN
MITSUBISHI ELECTRIC EUROPE B.V. Travellers Lane UK Hatfield, Herts. AL10 8XB Phone: +44 (0)1707/27 61 00	UK

EUROPEAN REPRESENTATIVES

GEVA Wiener Straße 89 AT-2500 Baden Phone: +43 (0)2252/85 55 20	AUSTRIA	AutoCont.CS.s.r.o. Technologická 374/6 CZ-708 00 Ostrava-Pustkovec Phone: +420 595 691 150	CZECH REPUBLIC	KAZPROMAUTOM.Ltd. Mustafina Str.7/2 KAZ-470046 Karaganda Phone: +7 7212/50 11 50	KAZAKHSTAN	Beijer Electronics AS Postboks 487 NO-3002 Drammen Phone: +47 (0)32/24 30 00	NORWAY	INEA d.o.o. Stegje 11 SI-1000 Ljubljana Phone: +386 (0)1/513 8100	SLOVENIA	ILAN & GAVISH Ltd. 24 Shenkar St., Kiryat Arie IL-49001 Petah-Tiqva Phone: +972 (0)3/922 18 24	ISRAEL
TEHNIKON Oktyabrskaya 16/5, Off. 703-711 BY-220030 Minsk Phone: +375 (0)17/210 46 26	BELARUS	B-ELECTRIC.s.r.o. Mladoboleslavská 812 CZ-197 00 Praha 19 - Kbely Phone: +420 286 850 848	CZECH REPUBLIC	Beijer Electronics SIA Vestnesis iela 2 LV-1035 Riga Phone: +371 (0)784/2280	LATVIA	Sirius Trading & Services Aleea Lacul Morii Nr. 3 RO-060841 Bucuresti, Sector 6 Phone: +40 (0)21/430 40 06	ROMANIA	Beijer Electronics AB Box 426 SE-20124 Malmö Phone: +46 (0)40/35 86 00	SWEDEN	TEXEL ELECTRONICS Ltd. 2 Ha Umanut, P.O.B. 6272 IL-42160 Netanya Phone: +972 (0)9/863 39 80	ISRAEL
ESCO D & A Culliganlaan 3 BE-1831 Diegem Phone: +32 (0)2/717 64 30	BELGIUM	Beijer Electronics A/S Lykkegårdsvej 17, 1. DK-4000 Roskilde Phone: +45 (0)46/75 76 66	DENMARK	Beijer Electronics UAB Savanoriu Pr. 187 LT-02300 Vilnius Phone: +370 (0)5/232 3101	LITHUANIA	Craft Con. & Engineering d.o.o. Bulevar Svetog Cara Konstantina 80-86 SER-18106 Nis Phone: +381 (0)18/292-24-45	SERBIA	Econotec AG Hinterdorfstr. 12 CH-8309 Nürensdorf Phone: +41 (0)44/838 48 11	SWITZERLAND	CEG INTERNATIONAL Lebanon-Beirut Phone: +961 (0)1/240 430	LEBANON
Koning & Hartman b.v. Woluwelaan 31 BE-1800 Vilvoorde Phone: +32 (0)2/257 02 40	BELGIUM	Beijer Electronics OÜ Pärnu mnt.160i EE-11317 Tallinn Phone: +372 (0)6/51 81 40	ESTONIA	ALFATRDE Ltd. 99, Paola Hill Malta-Paola PLA 1702 Phone: +356 (0)21/697 816	MALTA	INEA SR d.o.o. Izletnička 10 SER-113000 Smederevo Phone: +381 (0)26/617 163	SERBIA	GTS Bajraktar Bulvari Nutuk Sok. No:5 TR-34775 Yukari ISTANBUL Phone: +90 (0)216 526 39 90	TURKEY	CBI Ltd. Private Bag 2016 ZA-1600 Isando Phone: +27 (0)11/928 2000	SOUTH AFRICA
INEA BH d.o.o. Aleja Lipa 56 BA-71000 Sarajevo Phone: +387 (0)33/921 164	BOSNIA AND HERZEG.	Beijer Electronics OY Jaakonkatu 2 FIN-01620 Vantaa Phone: +358 (0)207/463 500	FINLAND	INTERESIS srl bid. Traian 23/7 MD-2060 Kishinev Phone: +373 (0)22/66 4242	MOLDOVA	AutoCont Control s.r.o. Radlinského 47 SK-02601 Dolny Kubin Phone: +421 (0)43/5868210	SLOVAKIA	CS Automation Ltd. 4-B. M. Rasikovoy St. UA-02600 Kiev Phone: +380 (0)44/494 33 55	UKRAINE		
AKHNATON 4 Andrej Ljapchev Blvd. Pb 21 BG-1756 Sofia Phone: +359 (0)2/817 6004	BULGARIA	UTECO A.B.E.E. 5, Mavrogenous Str. GR-18542 Piraeus Phone: +30 211/1206 900	GREECE	HIFLEX AUTOM. B.V. Wolveveerstraat 22 NL-2984 DC Ridderkerk Phone: +31 (0)180-46 60 04	NETHERLANDS	CS MTrade Slovensko, s.r.o. Vajnarskeho 58 SK-92101 Piestany Phone: +421 (0)33/7742 760	SLOVAKIA				
INEA CR d.o.o. Losinjka 4 a HR-10000 Zagreb Phone: +385 (0)1/36 940-01/-02/-03	CROATIA	MELTRADE Ltd. Fertő utca 14. HU-1107 Budapest Phone: +36 (0)1/431-9726	HUNGARY	Koning & Hartman b.v. Haarlerbergweg 21-23 NL-1101 CH Amsterdam Phone: +31 (0)20/587 76 00	NETHERLANDS						



Mitsubishi Electric Europe B.V. /// FA - European Business Group /// Gothaer Straße 8 /// D-40880 Ratingen /// Germany
Tel.: +49(0)2102-4860 /// Fax: +49(0)2102-4861 120 /// info@mitsubishi-automation.com /// www.mitsubishi-automation.com

Specifications subject to change /// Art. no. 224743-A /// 03.2009
All trademarks and copyrights acknowledged.